

**3 VISIONS OF MEGA-OPEN LABS IN FRANCE
HOW TO SUPPORT THE REVITALIZATION OF AN
ECOSYSTEM AND PREPARE FOR DISRUPTIONS**

Dr. David W. VERSAILLES
PARIS SCHOOL OF BUSINESS – newPIC chair
CEO, ISK CONSULTING SA

Acknowledgements

- This research has been commissioned by the French governmental agency Bpifrance Le Lab and the open lab Innovation Factory to the newPIC chair, at Paris School of Business.
- The project was headed by Prof. Valerie Merindol and Prof. David W. Versailles.
- <http://www.newPIC.fr>
- <http://innovfra.newpic.fr>



- Chinese text here

A definition of open labs

Open labs are platforms introduced to

- Contribute to open innovation, and generate the agility for digital innovation
- Host interactions between end-users and all stakeholders to the innovation process, incl. Startups, industry, universities, etc.

Open labs characterize with:

- A physical space,
- A community,
- Various services (incl. Fast prototyping, incubation, acceleration, coworking, etc)

- Chinese text here

The originality of France innovation system

- Universities play a minor role in the development of open labs
 - The open lab movement has a much greater momentum in France than in other Western European countries
 - 10+ instances of mega-open labs have emerged in France: they singularize with their size and with their great impact on the local ecosystem
- Chinese text here

3 instances of mega- open labs in France

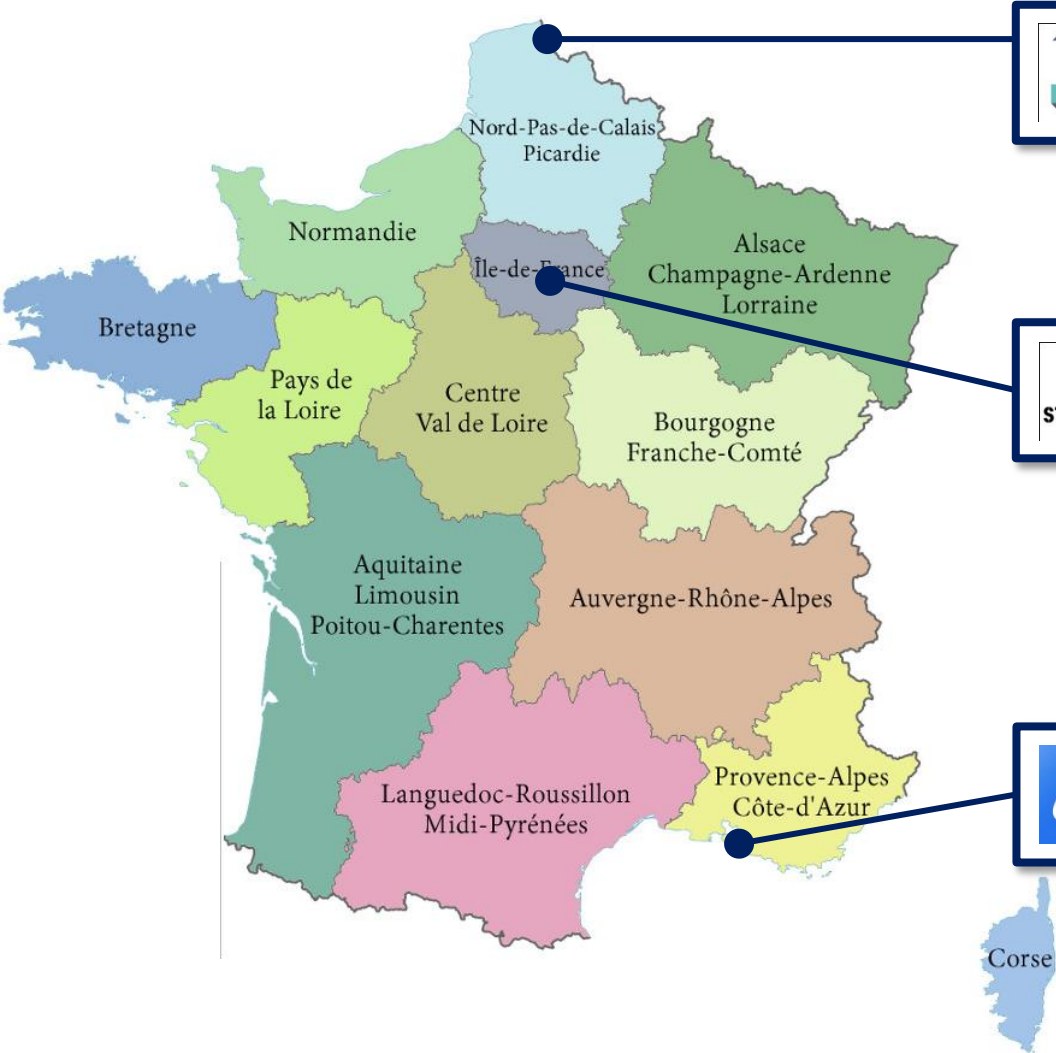

 **EURATECHNOLOGIES**
in LILLE



 **STATION F**
in PARIS



 **THE CAMP**
close to MARSEILLE



3 cases studies focused on digital innovation

Euratechnologies

- 10+y of history
- From the earliest stages of incubation to acceleration
- Rejuvenate the local ecosystem (local gov.)
- Chinese text here

Station F

- 1+y old, “1,000 startups”
- Business-oriented
- Platform hosting different open labs by large firms
- Focus on incubation
- Chinese text here

thecamp

- Almost 2y old
- Not for profit initiative launched by a billionaire
- Focus on the dissemination of disruptive innovation
- Chinese text here

5 key success factors

These instances of mega open labs

- **are installed in long time frames**
- **leverage on complementary skills and on a community of contributors**
- **use their physical space as a totem for their identity**
- **all hire staff with extensive previous experience in innovation and digital transformation**
- **leverage on their scale to propose a comprehensive portfolio of services, and generate greater attractivity**

■ **Chinese text here**

Long time frames

- **Stability of objectives, with high adaption capability**
- **Stability of governance**
- **Long lasting support by local stakeholders and by local governments**
- **No “bad” surprise in relation with budgets**
- **The strategy is widely understood (communication) which means that startups can plan their applications**



- **Chinese text here**

A strong community of contributors

- In each community, members support each other for their startups, and also eventually make business together
- The most important point relates to initiatives emerged from the communities themselves ('Next' and the label 'Ready' at Euratechnologies; the 'Hive' at thecamp)



- Chinese text here

The importance of the physical space

- The physical space serves as focal point for the members of the community
- It embodies (materializes) the identity of the open lab, and serves as reference for its strategy
- The physical space serves the emergence of serendipitous encounters, and materializes the openness of the lab



- Chinese text here

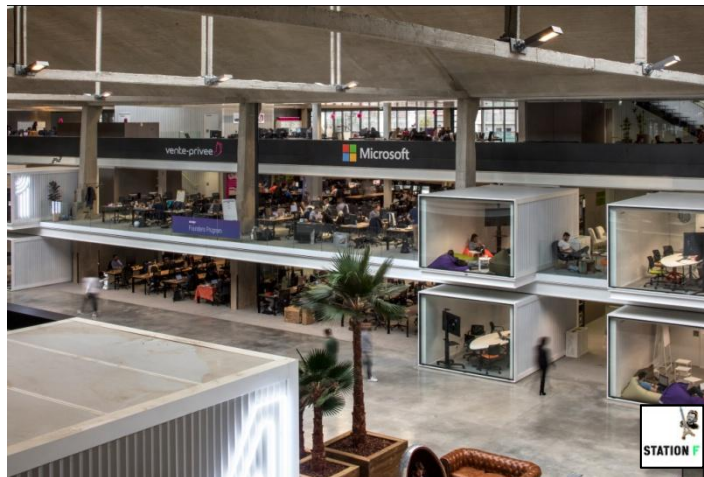

Staff with high level expertise

- **Mega open labs have a very large staff size (50+ at thecamp and at Euratechnologies)**
- **All staff members have explicit and demonstrated skills in the management of open innovation, of user-centric and non linear models of innovation**
- **Staff members are experts for the facilitation of projects**



- **Chinese text here**

Scalability transposed at open lab level

- Comprehensive portfolio of complementary services
- Only the size effect makes it possible to have variety, resources, attractivity and leverage to reach such a completeness
- This scale requires also important financial resources (e.g. the physical space), high level of staff excellence, and highly talented community



- Chinese text here

Contact details



Download our reports from the newPIC chair website: www.newPIC.fr

All reports are available for free (in French)

- **Innovation platforms in France (2018)** <http://innovfra.newpic.fr>
- **Innovation platforms in Paris and its region (2017)** <http://innovidf.newpic.fr>
- **White book on Open labs (2016)** <http://openlabs.newpic.fr>

▪ ISK CONSULTING SA

- eMail: info@iskconsulting.net
- fax: +352 (0) 671 01 21 58
- website: www.iskconsulting.net
- twitter: [@iskconsult](https://twitter.com/iskconsult)
- Instagram: [iskconsulting](https://www.instagram.com/iskconsulting)

▪ HQ

- address: 128 avenue du X Septembre
L-2550 Luxembourg
- Aut. Commerce: en cours

▪ Administrateur délégué

- **Pr Dr David W. VERSAILLES**
 - eMail: dwv@iskconsulting.net
 - gsm: +352 (0) 671 01 21 58
 - twitter: [@DWV13](https://twitter.com/DWV13)

▪ Administrateurs

- **Pr Dr Valérie MERINDOL**
 - eMail: vm@iskconsulting.net

Wrap up: 5 key success factors

These instances of mega open labs

- are installed in long time frames
- leverage on complementary skills and on a community of contributors
- use their physical space as a totem for their identity
- all hire staff with extensive previous experience in innovation and digital transformation
- leverage on their scale to propose a comprehensive portfolio of services, and generate greater attractivity

■ Chinese here



© DWV & VM, 2018
ISK CONSULTING SA
& PSB / newPIC